

Unverferth® Grain Handling

Front-fold single-auger grain carts



X-TREME
Grain Carts:

**Extreme reach —
Enhanced line of site**

Easiest
cleanout and
unloading with
X-TREME Grain
Carts!



Models 1319, 1119, 1019

EXTREME Reach, Durability With Unmatched Front-Folding Corner-Auger Performance

The lineup of Unverferth **X-TREME**® grain carts has never been more user friendly and efficient for handling your harvest. Models 1319, 1119 and 1019 feature a redesigned body with steeper slopes for enhanced cleanout. Pair that with our patented front-folding auger design for greater forward and side unloading reach and height, and you'll experience unloading ease and operator visibility like never before.

All **X-TREME** grain carts feature a patented auger that allows the upper portion to store diagonally along the front of the cart for extreme auger reach, beyond the cart's hitch. Add in the double flighting in the lower auger with a deep sump and you'll experience extreme unloading efficiency up to 620 bushels per minute.



***Four-Way Downspout** features a funnel design with front/rear rotation and side-to-side maneuverability for precisely controlling grain flow without splatter*

Features/Benefits

- Capacities of 1,300, 1,100 and 1,000 bushels.
- The single front-folding, corner-mounted auger is specifically designed to position the auger further to the front and to the side for enhanced line-of-sight from the tractor cab.
- The standard four-way, hydraulic-controlled downspout features over 3' 8" of front/rear and side-to-side movement for easily topping off trucks with minimal tractor maneuvering. Dual, auger-mounted LED lighting enhances nighttime operation.
- The auger connection features patented flex-drive coupler for optimum u-joint life and Continuous-Flow™ upper and lower flighting for enhanced unloading speed and grain quality.
- Full-length, computer-balanced extended-wear 7/16" thick flighting for longest life.
- Easy-to-use, gravity-flow cleanout door is wheel-operated and can be locked open for easy cleanout.
- Standard transport safety features include L.E.D. tail and turn lights, side marker lighting, reflective striping and transport chain.
- The gearbox features oversized gears and bearings that are encased in a durable aluminum gearbox housing are static-rated at 330 h.p. and dynamic-rated at 153 h.p. for long-term, trouble-free use.
- In-field rest stand allows faster auger raising and lowering for quickly returning to the combine.
- P.T.O. features a cut-out clutch for superior driveline protection and automatic reset.
- Silicone-sealed seams, durable primer undercoat and oven-baked enamel topcoat in choice of tractor red or green to resist corrosion.
- Weather-Guard rollover tarp with heavy-duty 18-oz. canvas to protect load contents is standard on the model 1319 and 1119 and optional on the model 1019.





High-flotation wheel and tire options

Undercarriage Choices

A wide variety of high-flotation wheel and tire options along with tracks are available to fit the producer's needs depending on model. The patented Equalizer tracks independently camber front-to-rear and side-to-side to follow ground contours and are available on models 1319 and 1119.

UHarvest® Data Management

- UHarvest® data management system provides full ISOBUS terminal or tablet operation while it automatically stores detailed information about each load. Easily track grower, farm, field, crop, variety, truck ID and destination for enhanced crop insurance reporting and farm management. An optional moisture sensor provides dry-bushel weight for greater detail. Data can be transferred to an office computer, or wirelessly uploaded to the included Slingshot account.
- UHarvest Lite is ISOBUS operated through the tractor's VT monitor and displays up to 400 unloading events showing weight, date and time.



UHarvest data management system



Model 410 scale



Model 520 scale

Weighing Solutions

- The model 410 scale package is specifically designed for ease of use and maximum productivity. The data can be sent to an optional attached printer or DataDownloader (DDL).
- The model 520 scale package's large, 26-character display provides automatic load logging and more detailed management options such as downloading field information from your computer to the scale for easily recording field data; includes USB drive and software.

Specifications

Unverferth X-TREME® Grain Carts

Model		1319		1119		1019	
Capacity* (bushels)		1300		1100		1000	
Tire/Track Size		1250/50x32 (201A8) Tire	42"x148" Track	900/65x32 (191A8) Tire	36"x131" Track	900/65x32 (191A8) Tire	36"x112" Track
Spindle Size		6"	7"	4 1/2"	6"	4 1/2"	6"
Hub Size		12-Bolt	-	10-Bolt	-	10-Bolt	-
Empty Weight (lbs.)		19,050	30,300	15,500	24,000	15,500	19,000
Tongue Weight - Full (lbs.)		6,295	6,295	6,000	6,000	5,730	5,730
Downspout Range of Motion	Side to Side	3'8"	3'8"	3'8"	3'8"	3'8"	3'8"
	Front/Rear	3'9"	3'9"	3'9"	3'9"	3'9"	3'9"
A		18'6"	18'6"	16'7"	16'7"	16'7"	16'7"
B	Spout Down	11'7"	11'7"	10'6"	10'6"	10'6"	10'6"
C		25'4"	25'4"	21'	21'	21'	21'
D		31'2"	31'2"	26'10"	26'10"	26'10"	26'10"
E	Spout Down	12'8"	12'8"	12'4"	12'4"	12'4"	12'4"
F	Spout Out	9'9"	9'9"	7'10"	7'10"	7'10"	7'10"
	Spout In	8'4"	8'4"	6'7"	6'7"	6'7"	6'7"
G		12'	12'2"	12'8"	12'8"	12'4"	12'4"
H		11'	11'2"	11'8"	11'8"	11'4"	11'4"
I		1'4"	1'2"	1'5"	1'5"	1'5"	1'5"
J		13'8"	13'8"	13'	13'	11'10"	11'10"
K	Spout Down	1'2"	1'2"	1'5"	1'5"	1'5"	1'5"
L	Undercarriage Width	15'3"	13'11"	14'2"	11'10"	14'2"	11'10"

*Capacities measured with #2 corn at 15% moisture, 56# test weight.



Wide variety of undercarriages

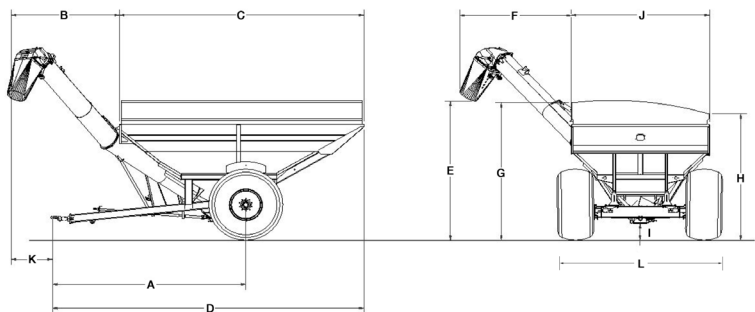

Take your harvest efficiency to the EXTREME! See your nearest Unverferth dealer today for complete details on the X-TREME models 1319, 1119 and 1019 grain carts or visit unverferth.com.

Due to continuing improvements in the design and manufacture of Unverferth products, all specifications contained herein are subject to change without notice.

Unverferth
Manufacturing Company, Inc.

P.O. Box 357 • Kalida, Ohio 45853
(419) 532-3121 • unverferth.com

©2018 Unverferth Manufacturing Co., Inc. Printed in U.S.A.

™Trademarks, registered or applied for, of Unverferth Manufacturing Co., Inc., Kalida, OH

Additional facilities in California, Georgia, Iowa, Nebraska, North Dakota, Oregon, Ontario and Saskatchewan Canada



XTREME178130800m5